

コニカルチューブミル Conical Tube Mill

テーパタイプ Tapered Type

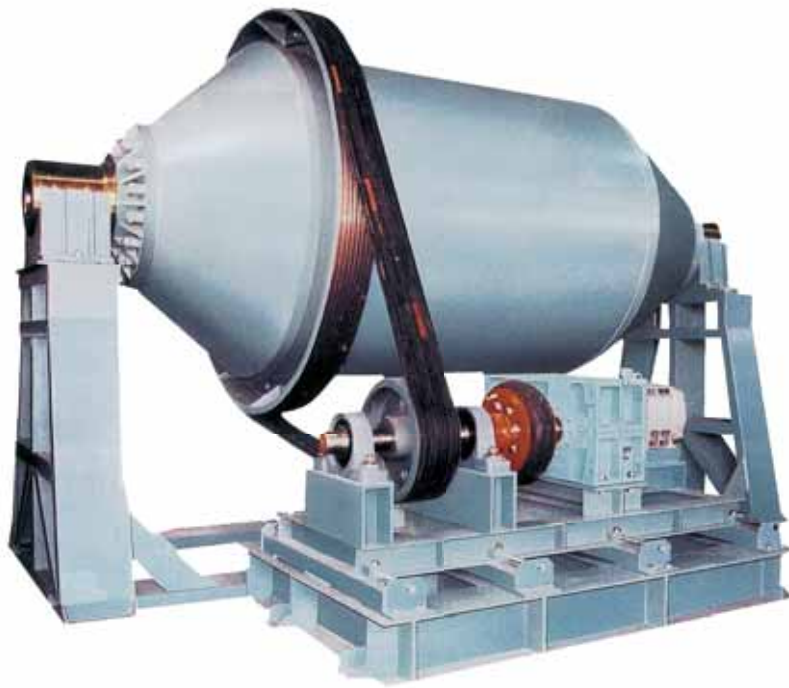

テーパ部のアルミナライニング

コニカルチューブミル

チューブミルと同じ連続式の微粉碎機ですが、チューブミルの側板がストレートに対して前後がテーパ形状（先細り）になっています。

シェルの部分を三つに分け、入口部分は急な形状に出口部分は緩やかな形状にして、遠心力の違いにより玉石の分布と粉碎物の分布を大粒なものから小粒なものになるように逆の分布を減らして粉碎効率を高めたものです。効率が高まることで省力化となり、内張り材の摩耗も減ることになります。

Conical Tube Mill

Conical Tube Mill is also same continuous operation type as Tube Mill.

Tube Mill has straight side shell, but Conical Tube Mill is tapered both at input and discharge points.

Shell is built in three sections. At the input point, there is a sharp angled section that allows a fast flow of material into the mill. At the discharge point, there is a shallower angled conical section that allows a smoother discharge from the mill.

The difference in these angles also cause a difference in the centrifugal force exerted on the bigger and smaller balls, making the machine highly efficient during operation. There are also economical savings in energy and the linings of these type of Mills wear out at a much slower rate.

- Built to the highest quality and efficiency standards.
- Designed for continuous flow through operation to save labour in the process.
- Suitable for either wet or dry pulverization, (Powder or Slurry output).
- This mill can be designed to handle various types of materials, Ceramics, Minerals and Chemicals.
- It offers enhanced grinding capability as it minimizes reverse distribution of the material.
- Mill can be lined with stone, rubber, alumina ceramic bricks (wet and dry types), and manganese.

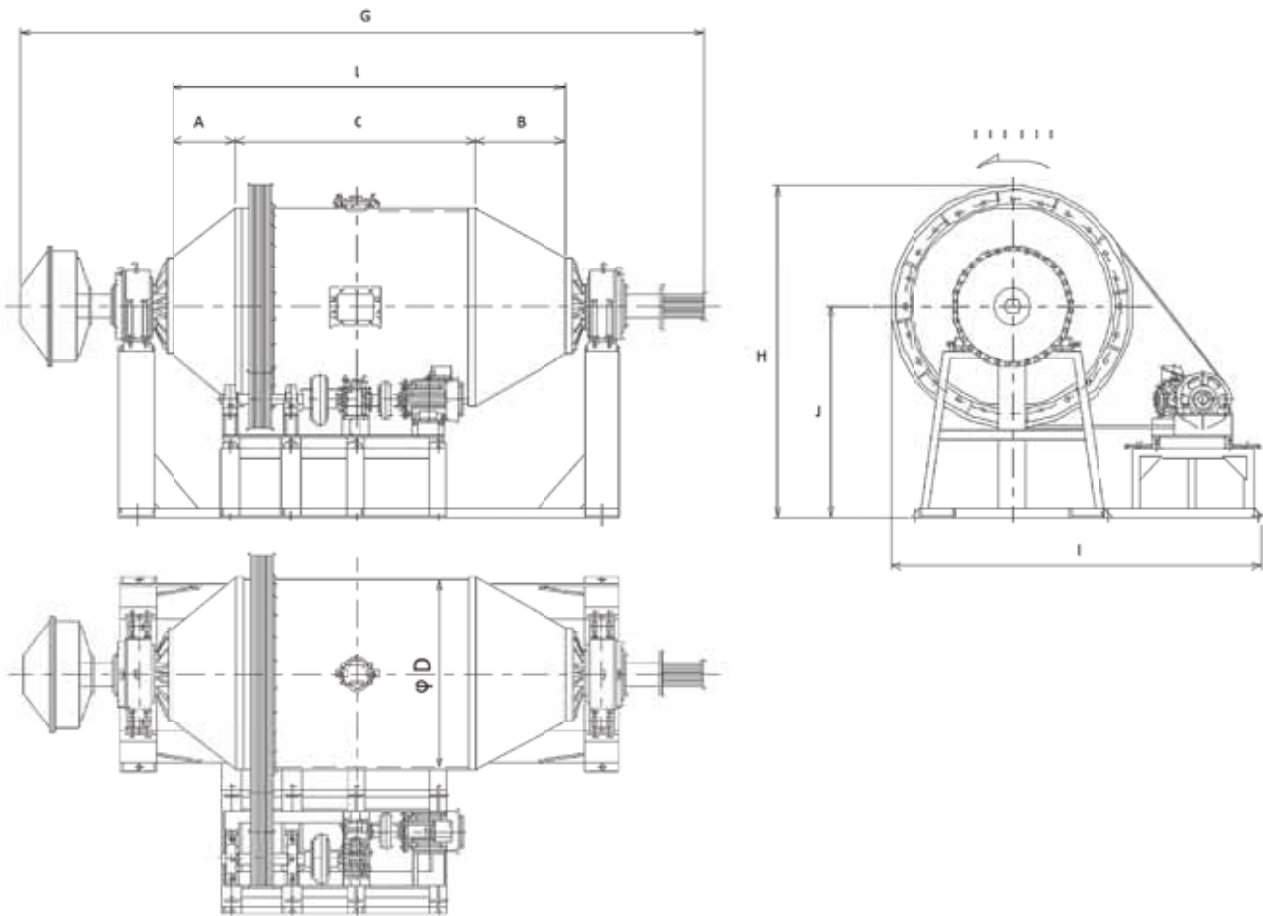

Conical Tube MILL コニカルチューブミル内貼後の内容積
 Capacity : With Linings Installed

(Unit : Litres)
 単位:リットル

Model Number	Alumina アルミナレンガ	Rubber ゴム	Natural Stone 天然石
CM 865 × 2000	600	600	400
CM 1200 × 2100	1,400	1,400	1,000
CM 1680 × 4200	6,200	6,100	4,400
CM 1820 × 4850	8,800	8,700	6,500
CM 1820 × 6060	11,600	11,400	8,600
CM 2100 × 4300	9,700	9,600	7,400
CM 2400 × 4900	14,700	14,600	11,500

Note: Above Figures are approximate and may change when improvements are made.

Conical Tube MILL コニカルチューブミル寸法
 Measurements of each section (Unit : mm)

単位:ミリメートル

Model Number	A	B	C	D	G	H	I	J	L
CM 865 × 2000	500	500	1000	865	3150	1620	2560	1000	2000
CM 1200 × 2100	450	450	1200	1200	3250	1800	2900	1200	2100
CM 1680 × 4200	600	900	2700	1680	5300	2860	3320	1800	4200
CM 1820 × 4850	600	900	3350	1820	6610	2900	3700	1700	4850
CM 1820 × 6060	600	900	4560	1820	7460	2520	4940	1250	6060
CM 2100 × 4300	700	1000	2600	2100	7300	3630	3840	2300	4300
CM 2400 × 4900	700	1200	3000	2400	7434	4600	4570	3110	4900

Note:

- 1) Figures are Approximate.
- 2) D and L are before applying Inner Linings. DとLは内貼前の寸法です。
- 3) Above Sizes may change when improvements are required.

注意:上記の数値等はあくまでも参考値で実際の数値とは異なることがあります。